

# SOUTH ROAD SUPERWAY TRAFFIC CHANGES

## Grand Junction Road / South Road intersection

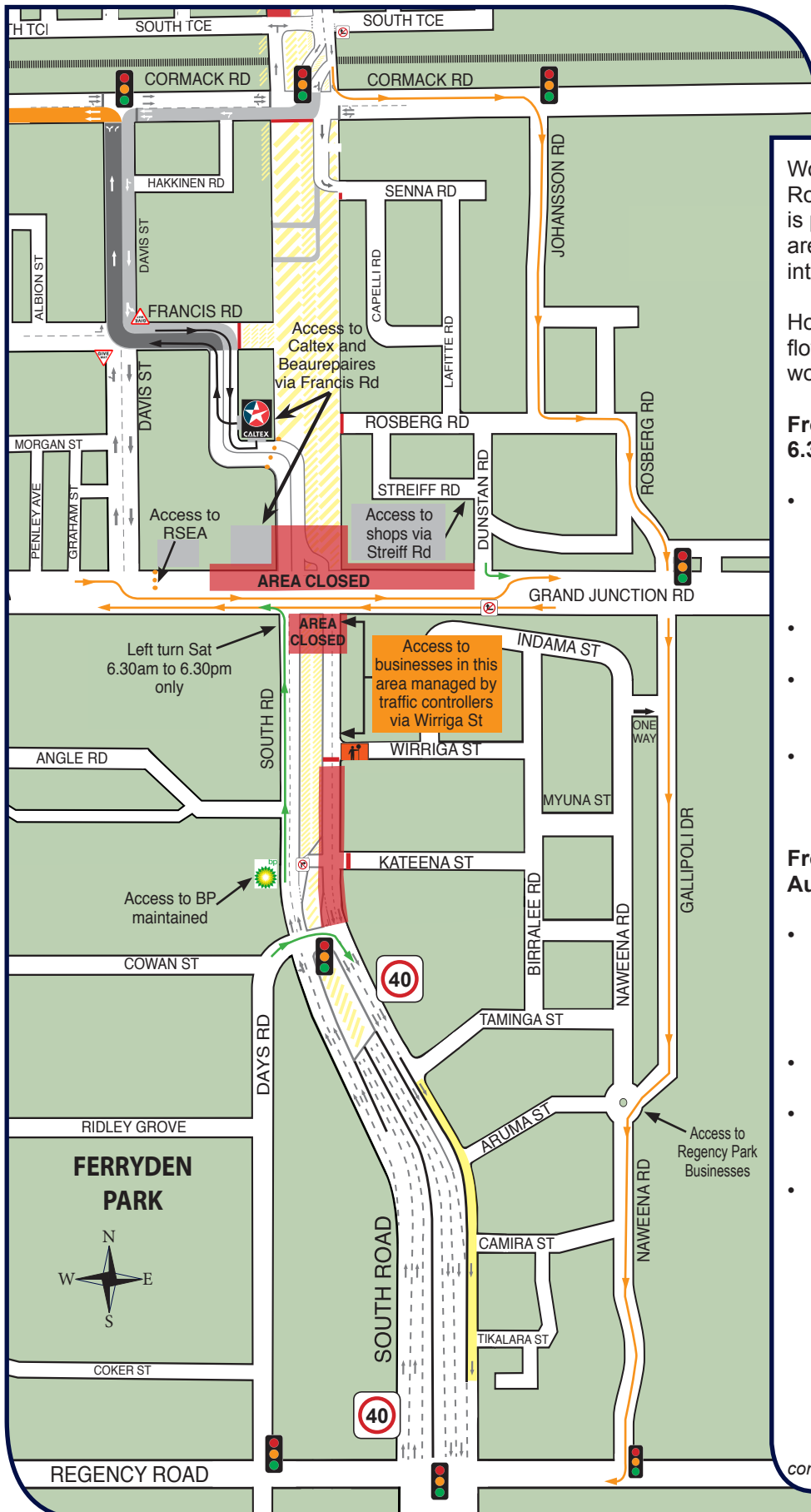

Work to reconstruct the Grand Junction Road and South Road intersection is progressing well with work in the area this weekend not requiring a full intersection closure.

However there will be changes to the flow of traffic in the area for asphalt work.

**From 6.30pm Friday 16 August to 6.30am Saturday 17 August 2013:**

- Eastbound traffic on Grand Junction Road will contra flow to the westbound lanes. One lane of traffic in each direction will be maintained on Grand Junction Road.
- There will be no access to South Road from Grand Junction Road.
- South Road northbound traffic will detour to Gallipoli Drive via Kateena Street.
- Angle Road and Werriga Street will be closed during this time.

**From 6.30am to 6.30pm Saturday 17 August 2013:**

- Eastbound traffic on Grand Junction Road will contra flow to the westbound lanes. One lane of traffic in each direction will be maintained on Grand Junction Road.
- There will be no access to South Road from Grand Junction Road.
- Northbound traffic on South Road will only be able to turn left at the Grand Junction Road intersection.
- Werriga Street and Kateena Street will be closed during this time.

*continued overleaf*

\* This map is indicative only and not to scale



Urban Superway, comprising John Holland Pty Ltd and Leed Engineering and Construction Pty Ltd, is the design and construction contractor delivering the \$842 million Australian and South Australian government funded South Road Superway with the Department of Planning, Transport and Infrastructure.

# SOUTH ROAD SUPERWAY TRAFFIC CHANGES

## Grand Junction Road / South Road intersection

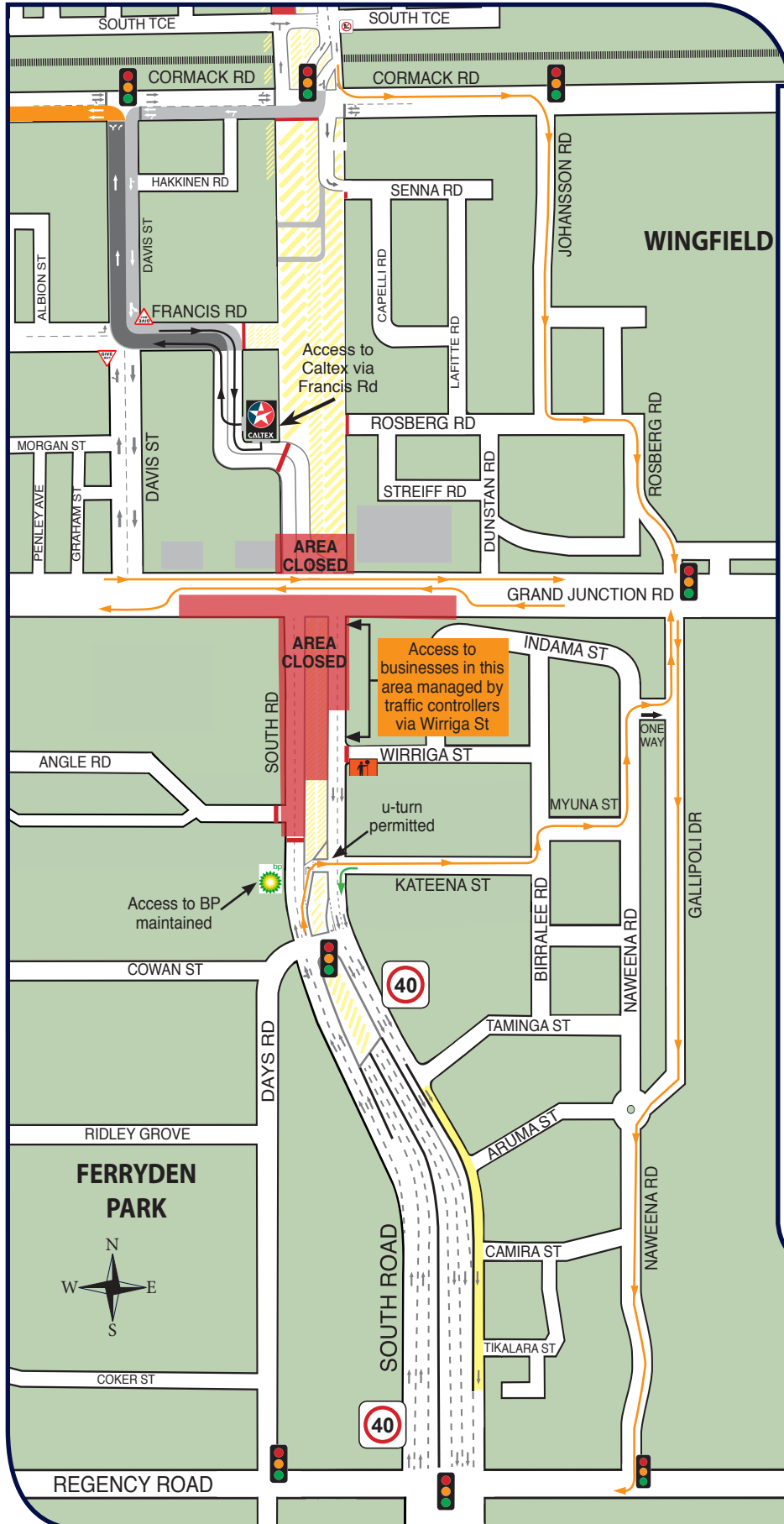

**From 6.30pm Saturday 17 August to 6.30am Monday 19 August 2013:**

- Westbound traffic on Grand Junction Road will contra flow to the eastbound lanes. One lane of traffic in each direction will be maintained on Grand Junction Road.
- There will be no access to South Road from Grand Junction Road.
- South Road northbound traffic will detour to Gallipoli Drive via Kateena Street.
- Angle Road and Wirriga Street will be closed during this time.

These activities cannot be completed in wet weather, therefore these dates may change.

For more information about this work or any other aspect of the project, please call the project information line on **1300 638 789** or email the [contactus@urbansuperway.com.au](mailto:contactus@urbansuperway.com.au)

Construction area

\* This map is indicative only and not to scale



Urban Superway, comprising John Holland Pty Ltd and Leed Engineering and Construction Pty Ltd, is the design and construction contractor delivering the \$842 million Australian and South Australian government funded South Road Superway with the Department of Planning, Transport and Infrastructure.